

SIDE ELEVATION

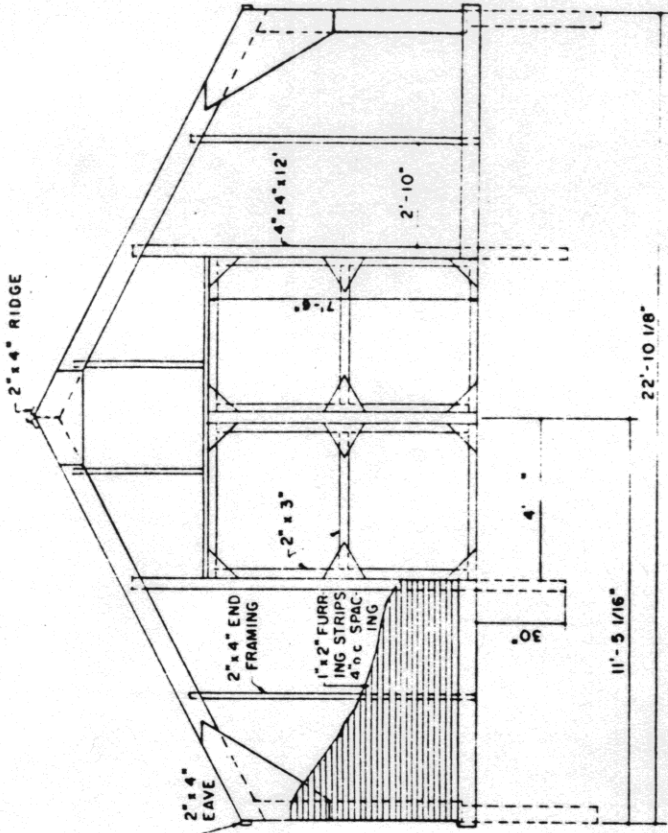

END ELEVATION

NOTE:
END WALLS MAY BE LEFT OPEN IF
STRUCTURE IS USED FOR RETAIL SALES

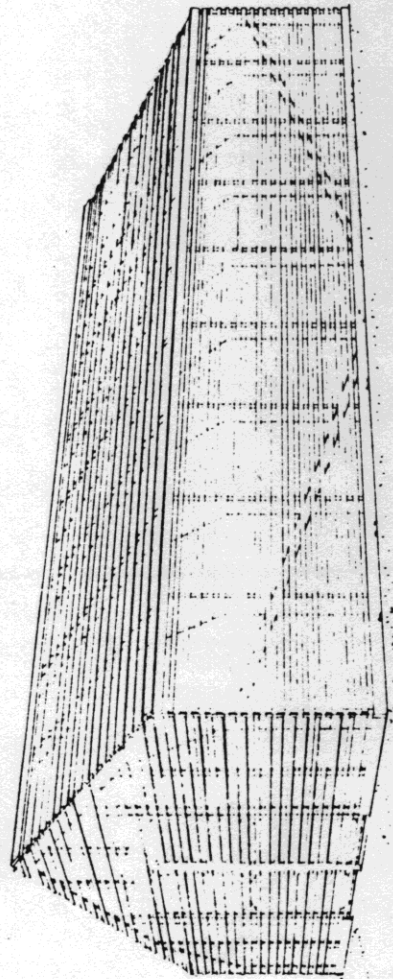

PERSPECTIVE

COOPERATIVE EXTENSION WORK IN AGRICULTURE AND HOME ECONOMICS			
AND UNITED STATES DEPARTMENT OF AGRICULTURE COOPERATING			
LATH HOUSE			
CONN.	69	EX. 6064	SHEET 1 OF 2

UNIV. OF CONN. PLAN NO. 236
J. W. BARTON, JR.
R. E. PHILLIPS

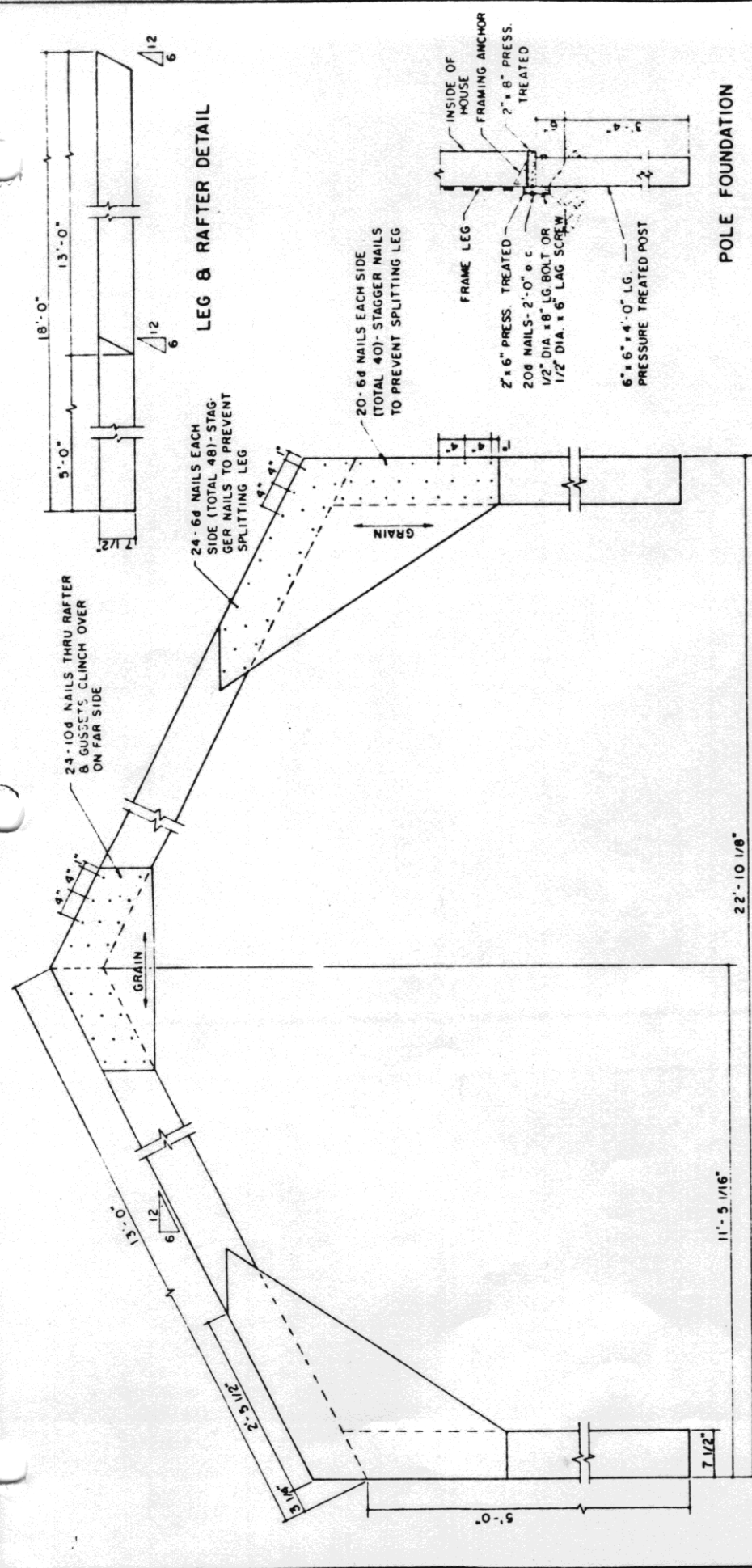

LEG & RAFTER DETAIL

POLE FOUNDATION

FRAME DETAIL

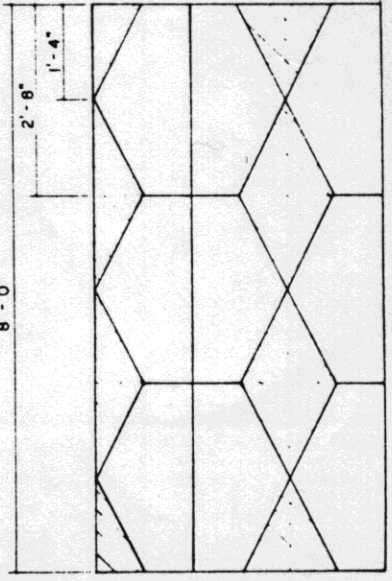

CROWN GUSSET CUTTING DIAGRAM

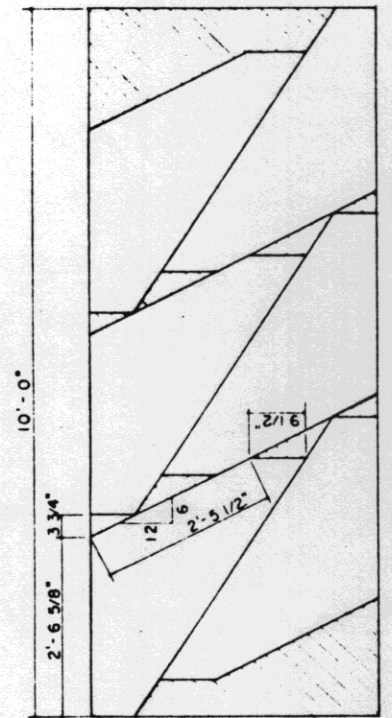

EAVE GUSSET CUTTING DIAGRAM

- NOTES**
1. USE 3/8" STRUCTURAL I PLYWOOD FOR GUSSETS
 2. FRAME MEMBERS TO BE CONSTRUCTION GRADE FIR, MINIMUM FIBER STRESS OF 1500 LB/SQ IN
 3. PRESSURE TREATED MATERIAL SHALL BE CONSTRUCTION GRADE FIR & SHALL BE PRESURE TREATED TO A PRESERVATIVE ATTENTION OF 5-7 POUNDS PER CUBIC FOOT AS PER A W P A STANDARDS.